



Aluminium Scaffold Towers Ltd.

01353 778811 sales@aluminium-scaffoldtowers.co.uk

www.aluminium-scaffoldtowers.co.uk

MDIY 5++ Aluminium Scaffold Tower (eDIY + Stifferens)

Tower Dimension : 0.6m(W) x 1.55m(L) x 3.80m(H)
 Platform Height : 2.7m, Max. Working Height : 4.7m

Safety Working Load : Platform - 150 kg when load uniformly distributed

Item	Description	Qty.
1.	DIY 6 Rung Base Frame	2
2.	DIY 6 Rung End Frame	2
3.	DIY Combination Brace	2
4.	DIY Horizontal Brace	2
5.	DIY Diagonal Brace	2
6.	DIY Trapdoor Platform 500 x 1550	1
7.	Base Bar Unit (c/w Ø100mm Castor)	1
8.	Base Bar Assemble Unit	1
9.	Stifferens	4
10.	DIY Horizontal Brace (Optional)	2
11.	Wooden Toeboard Set (Optional)	1
12.	Telescopic Outrigger (Optional)	4

Scale : NTS

Ref. : MDIY-300-5000+

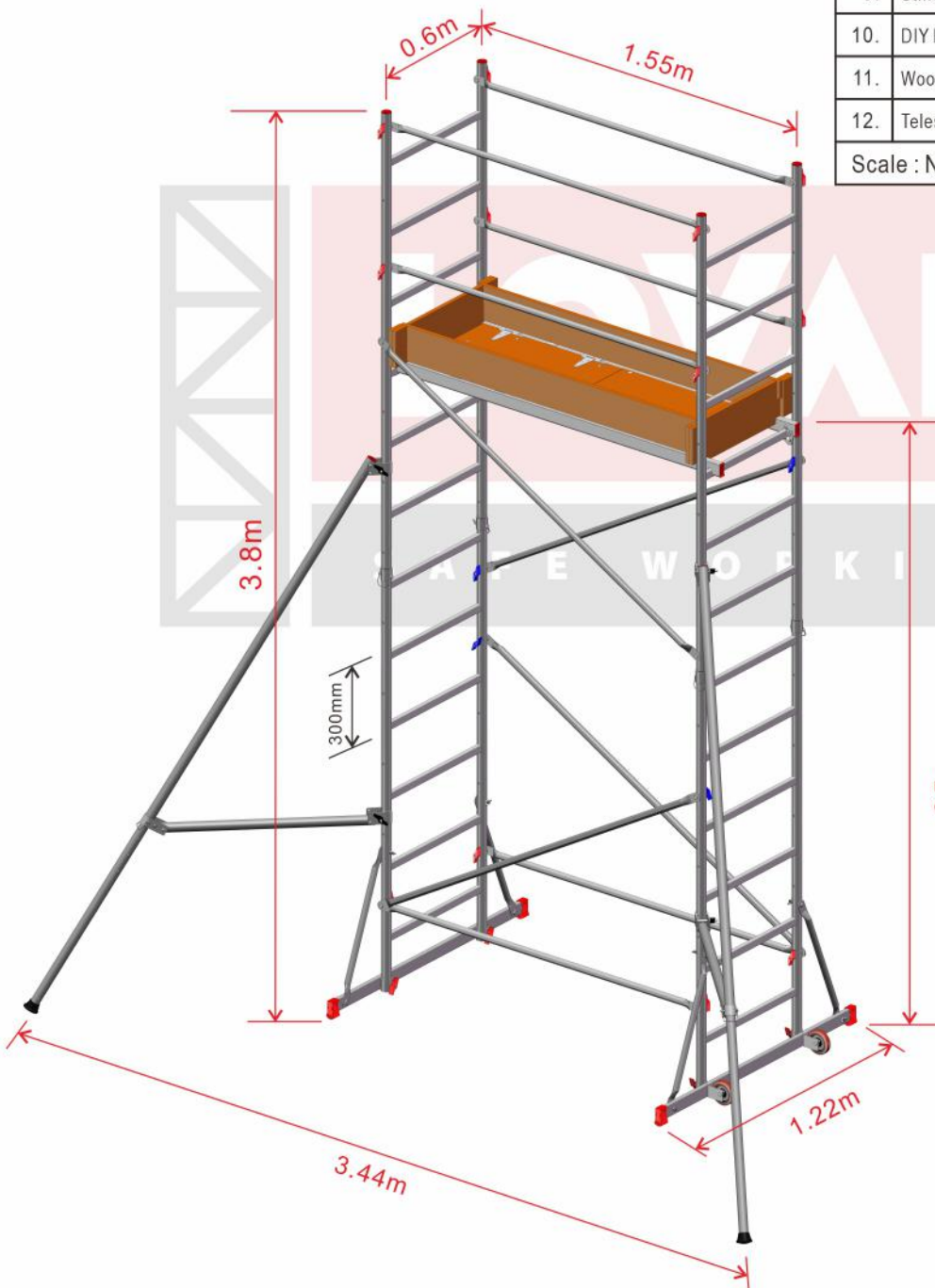

2.7m

3.44m

1.22m

3.8m

300mm

0.6m

1.55m